



BACKSTAGE FLOOR PLAN - NEW WORK
SCALE: 1/8"=1'-0"

INTERIOR WALL TYPE LEGEND

6" STI STUDS @ 16" O.C. TO DECK OR STRUC ABOVE. 5/8" GWB EA SIDE. W/ EXTEND TO F" ABOVE CL.G. BRACE TO DECK OR STRUCTURE @ 42" O.C. MIN.	3" SF STI STUDS @ 16" O.C. TO DECK OR STRUC ABOVE. 5/8" GWB EA SIDE. W/ EXTEND TO F" ABOVE CL.G. BRACE TO DECK OR STRUCTURE @ 42" O.C. MIN.	3" SF STI STUDS @ 16" O.C. TO DECK OR STRUC ABOVE. 5/8" GWB ONE SIDE. W/ EXTEND TO F" ABOVE CL.G.	1 1/2" FAT CHANNEL @ 16" STI STUDS @ 16" O.C. TO DECK OR STRUC ABOVE. 5/8" GWB ONE SIDE. W/ EXTEND TO F" ABOVE CL.G.	7/8" FAT CHANNEL @ 16" STI STUDS @ 16" O.C. TO DECK OR STRUC ABOVE. 5/8" GWB ONE SIDE. W/ EXTEND TO F" ABOVE CL.G.
6" STI STUDS @ 16" O.C. TO DECK OR STRUC ABOVE. 5/8" GWB EA SIDE. FIRE TAPE EACH FACE. FOR ADDITIONAL DETAIL REFERENCE: REASSEMBLY # 13.12 2 HR RATING. AND FIRE SAVING AT TOP AND BOTTOM OF WALLS AND AROUND ALL PENETRATIONS.	3" SF STI STUDS @ 16" O.C. TO DECK OR STRUC ABOVE. 5/8" GWB EA SIDE. FIRE TAPE EACH FACE. FOR ADDITIONAL DETAIL REFERENCE: REASSEMBLY # 13.12 2 HR RATING. AND FIRE SAVING AT TOP AND BOTTOM OF WALLS AND AROUND ALL PENETRATIONS.	6" CMU TO DECK ABOVE STANT AND FIRE SAVING AT TOP AND SIDES OF WALLS AND AROUND ALL PENETRATIONS.	6" CMU TO DECK ABOVE STANT AND FIRE SAVING AT TOP AND SIDES OF WALLS AND AROUND ALL PENETRATIONS.	4" CMU TO DECK ABOVE STANT AND FIRE SAVING AT TOP AND SIDES OF WALLS AND AROUND ALL PENETRATIONS.

- KEYNOTES - NEW WORK**
1. STONE COUNTER AND BACK SPLASH MOUNTED TO STEEL ANGLE FRAME SUPPORT.
 2. UNDERMOUNTED LAVATORY IN COUNTER. PROVIDE ADA COMPLIANT PIPE WRAP ON ALL SINKS.
 3. FULL HEIGHT MIRROR ABOVE BACKSPLASH.
 4. CEILING HUNG STAINLESS STEEL TOILET PARTITIONS.
 5. CEILING HUNG STAINLESS STEEL TOILET PARTITIONS.
 6. ELECTRIC HAND DRYER.
 7. WALL MOUNTED STAINLESS STEEL URINAL PARTITIONS.
 8. WALL MOUNTED STAINLESS STEEL URINAL PARTITIONS.
 9. WALL MOUNTED STAINLESS STEEL URINAL PARTITIONS.
 10. 24" D BASE CABINETS W/ STONE COUNTER.
 11. NEW PLUMBING STAIN GARDER MOUNTED COSSING WALL TREATMENT.
 12. NEW PLUMBING STAIN GARDER MOUNTED COSSING WALL TREATMENT.
 13. STONE CONSESSION BAR COUNTER.
 14. RECESSED WATER COOLER AND BACK SPLASH MOUNTED TO STEEL ANGLE FRAME SUPPORT.
 15. 12" DEEP WALL MOUNTED PLAIN SHELVING ABOVE DRESSING TABLES.
 16. 12" DEEP WALL MOUNTED PLAIN SHELVING ABOVE DRESSING TABLES.
 17. 24" DEEP PLAIN SHELVING ABOVE WALL MOUNTED COSTUME HANGING HOOD.
 18. NEW STAIN GRADE WOOD BENCH, STAIN AND SEAL.
 19. NEW STAIN GRADE WOOD BENCH, STAIN AND SEAL.
 20. SURFACE MOUNTED PAPER TOWEL DISPENSER AND TRASH RECEPTACLE.
 21. SANITARY PRODUCT DISPENSER.
 22. BABY CHANGING STATION.
 23. 24" D PLAIN BASE CABINETS AND SOLID SURFACE COUNTER. 12" D PLAIN WALL CABINETS AND SOLID SURFACE COUNTER.
 24. 24" D PLAIN BASE CABINETS AND SOLID SURFACE COUNTER. 12" D PLAIN WALL CABINETS AND SOLID SURFACE COUNTER.
 25. NEW REFRIGERATOR. AMANA MODEL AS2022ZWS.
 26. NEW REFRIGERATOR. AMANA MODEL AS2022ZWS.
 27. RESTORE 1/2" CONC. SLAB AS REQUIRED AFTER INSTALLATION OF NEW PLUMBING AND WASTE PIPING. REF. PLUMBING DRAWINGS FOR ALL LOCATIONS AND ADDITIONAL INFORMATION.

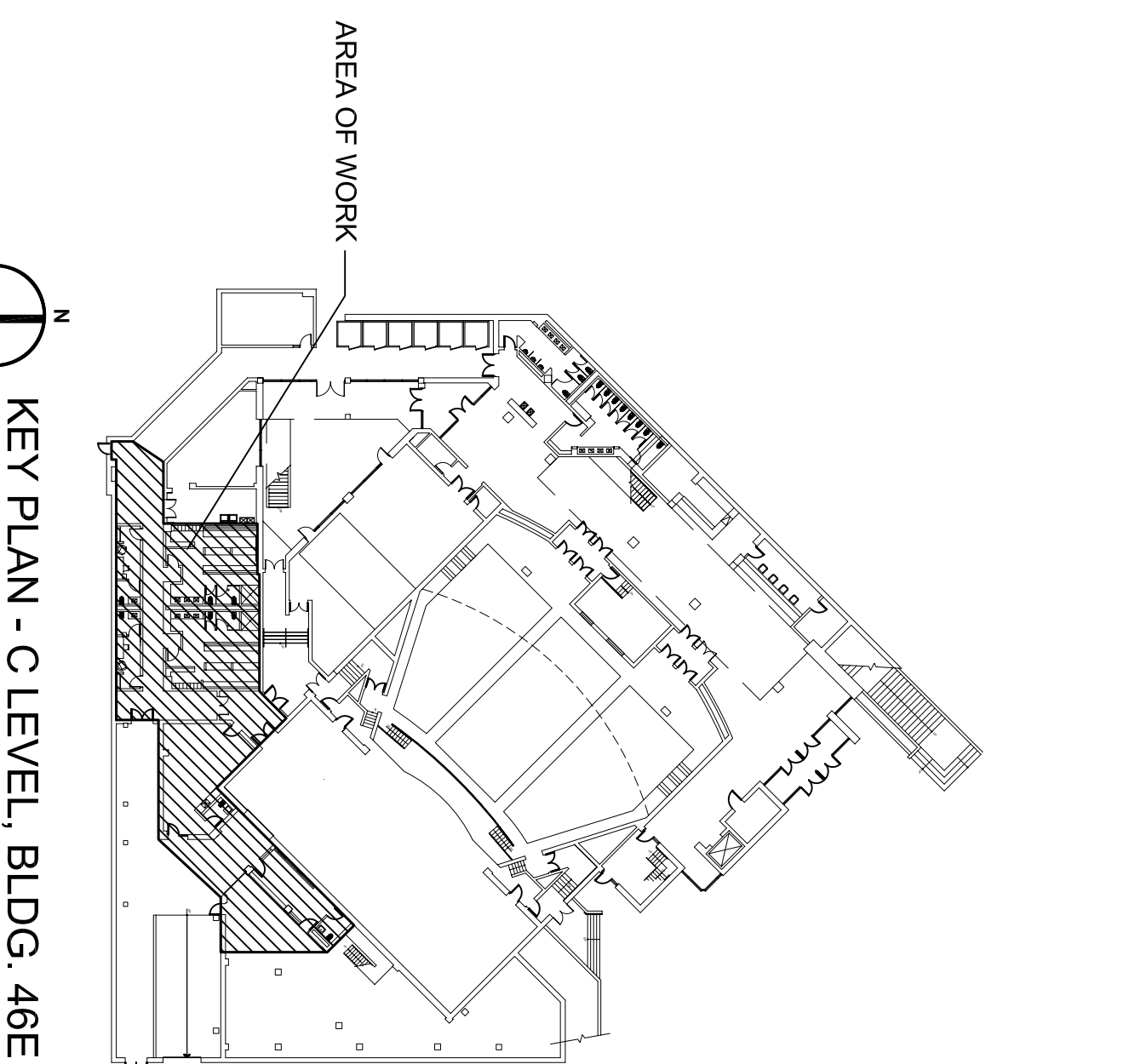

OWNER:
UNIVERSITY OF DISTRICT OF COLUMBIA
4200 Connecticut Avenue, NW
Washington, DC 20008

RENOVATION OF GUEST ROOMS & DRESSING ROOMS AT THE CAMPUS AUDITORIUM BUILDING 48E, UDC VAN NESS CAMPUS
BID PACKAGE - 2
INTERIOR RENOVATIONS - FRONT OF HOUSE AND BACK OF HOUSE
architect:

KAMM ARCHITECTURE
3812 Van Ness Street, NW
Washington, DC 20016
phone 202.249.2901
fax 202.249.2902

building envelope engineers:
sgn
simpson gumpertz & hager, inc.
1828 L Street, NW
Washington, DC 20036
phone 202.239.4199
fax 202.239.4198

m.e.p. engineers:
sai
sai and associates, intl., inc.
5185 MacArthur Blvd Suite, 106
Washington, DC 20016
phone 202.393.1523
fax 202.315.5099

specifications:
h&m
heller and metzger, inc.
11 Dupont Circle NW, Suite 601
Washington, DC 20036
phone 202.364.2222
fax 202.234.5502

cost estimating:
aed
Advanced Engineering Design, Inc.
6525 Balcones Road, Suite 521
Hyattsville, MD 20782
phone 301.683.2110
fax 240.465.0653

revisions:	date
AMENDMENT #2 TRK 01/07/2013	
rev	date
drawn by:	YAS
checked by:	TAK
project number:	1013
drawing title:	BACKSTAGE FLOOR PLANS - NEW
scale:	1/8" = 1'-0"
date:	10.31.2012